

# the Joule™ Turbo Sous Vide

Safety Guide – BSV600



**Breville®**



## Contents

- 2 Breville® Recommends Safety First
- 8 Components
- 9 Accessory
- 10 How To Use The Joule
- 12 How To Use The Provided Ruler
- 13 How To Use The Clamp
- 13 Storing The Joule
- 14 Care & Cleaning
- 16 Limited Product Warranty

## BREVILLE® RECOMMENDS SAFETY FIRST

At Breville® we are very safety conscious. We design and manufacture consumer products with the safety of you, our valued customer, foremost in mind. In addition, we ask that you exercise a degree of care when using any electrical appliance and adhere to the following precautions.

## IMPORTANT SAFEGUARDS

**READ ALL INSTRUCTIONS  
BEFORE USE AND SAVE FOR  
FUTURE REFERENCE**

A downloadable version of this document is also available at **breville.com**  
Please read the following safety instructions and warnings before operating Joule:

- Joule is intended for counter use only.
- Joule is intended for use with water only.
- Follow proper kitchen sanitation and sous vide packaging practices. Consuming raw or undercooked meats, poultry, seafood, shellfish, eggs, or unpasteurized milk may increase risk of foodborne illness. Use only food-safe packaging.
- Spilled food or liquid can cause serious burns. Never use an outlet below the counter, and never use with an extension cord. Always keep the cord outside the reach of children or pets to avoid hot water-related injuries.
- Please be careful when removing bags or jars from water heated with Joule, as they can be very hot to the touch. We strongly recommend using tongs or jar lifters.
- To ensure continued protection against risk of electric shock, connect to properly grounded outlets only.
- Cooking with Joule can cause containers to become very hot to the touch. Do not touch hot surfaces and use oven mitts when handling cooking containers.

- While it is running, do not remove Joule from water-it could spray hot water and cause injury.
- Always turn Joule off, unplug the unit and wait for it to cool, before removing it from water.
- The clip can become hot during cooking. Allow it to cool before handling. The metal foot can also become hot from sitting in heated water. Allow it to cool before handling.
- After unplugging, the heater will remain hot and should not be placed on combustible surfaces.
- Unplug Joule when not in use and before cleaning. Allow it to cool before removing or replacing parts.
- This appliance can be used by children 8 years and above, persons with reduced physical, mental, or sensory capabilities if supervised or instructed and understand the hazards involved.
- Cleaning and user maintenance shall not be made by children without supervision.
- Keep small parts (propeller and bumper) out of reach of children.
- Children shall not play with the appliance.

- Do not operate any appliance with a damaged cord or plug, or after the appliance malfunctions or has been damaged. Return appliance to the nearest authorized service facility for examination, repair, or adjustment.
- The supply cord cannot be replaced. If the cord is damaged the appliance should be scrapped.
- Accessory attachments not explicitly recommended by the appliance manufacturer may cause injuries.
- Joule is not intended to be operated by means of an external timer or separate remote-control system.
- Do not use outdoors.
- Do not let cord hang over edge of table or counter or touch hot surfaces.
- Do not place Joule on or near a hot gas or electric burner, or in a heated oven.
- Only use vessels which can withstand high temperatures.
- Extreme caution must be used when moving a pot or container full of hot water. Never reach into the water with your hands. Temperatures above 122 °F / 50 °C can scald.

- To avoid risk of hot water splashing from the cooking vessel, leave at least one inch (25mm) of space between the surface of the water and the top of your cooking vessel.
- Do not use appliance for uses other than those intended by the manufacturer.
- Keep the magnetic metal foot away from cardiac pacemakers and active implantable medical devices (AIMDs). Magnetic interference could impact the functioning of AIMDs.

## **NOTE**

To reduce the risk of damaging countertops:

- Don't use Joule in pots or vessels placed directly on countertops made of materials such as quartz, granite, or marble, as doing so may damage the countertop. Please consult your countertop manufacturer's use instructions, and always use Joule with a thick, sturdy trivet or potholder rather than placing the pot directly on the countertop. A dish towel may not effectively protect the countertop from damage.



## **WARNING**

On cord length and cancelling remote operation:

- A short power-supply cord is provided to reduce the risk resulting from becoming entangled in or tripping over a longer cord.
- Unplugging Joule at any time will stop Joule immediately as well as override any existing cook program or remote controls.

## **Radio Waves**

Joule radiates radio waves according to the following frequency bands:

- Wi-Fi frequency range:  
2.412 – 2.462 GHz
- Bluetooth frequency range:  
2.402 – 2.48 GHz
- Maximum radio-frequency power transmitted in the frequency band(s) in which the radio equipment operates is 20.5dBm.

**FOR HOUSEHOLD  
USE ONLY**

**SAVE THESE  
INSTRUCTIONS**



## Components

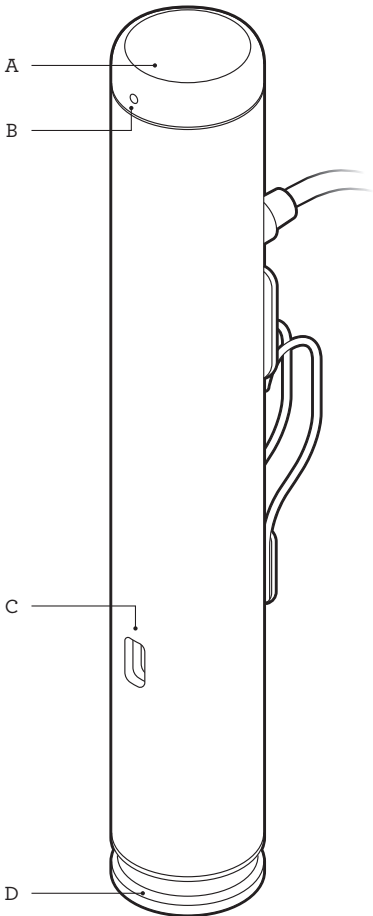

- A. Top button
- B. Notification LED
- C. Water outlet
- D. Magnetic foot





## Accessory

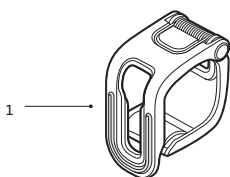

1. Big Clamp  
(sold separately)



### NOTE

To install the clamp, first remove by sliding down the attached clip from the joule and then replace by sliding up the 'Big Clamp' in place.

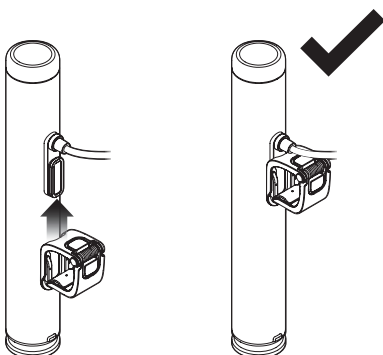



# How To Use the Joule

1.1



JTQR1



1.2

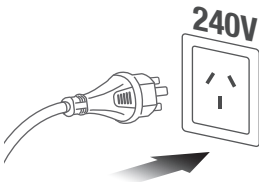

1.3

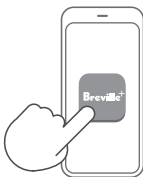

1.4

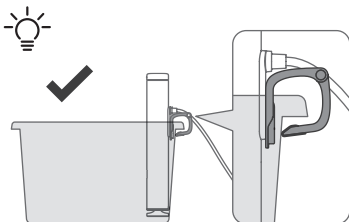
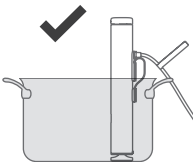

1.5



1.6

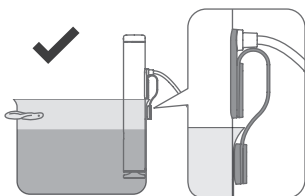

OR

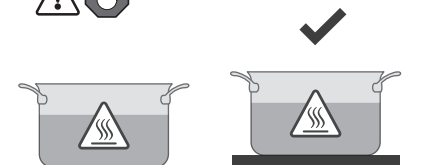
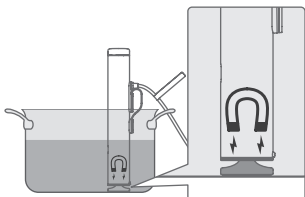

1.7

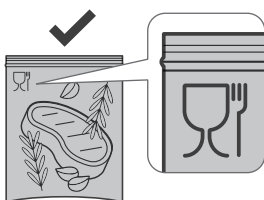
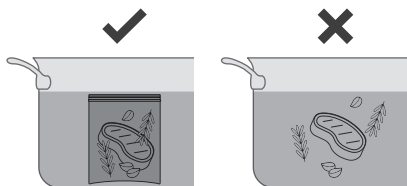

1.8

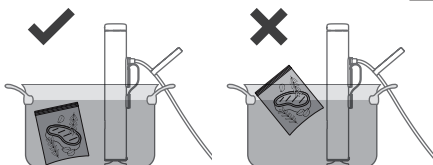

MIN  
25 mm



1.9

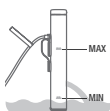
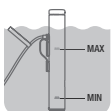
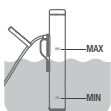

MIN  
3.75 L



## How To Use The Provided Ruler

2.1

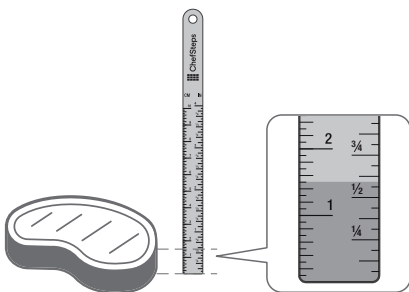

2.2





## How To Use The Clamp

3.1

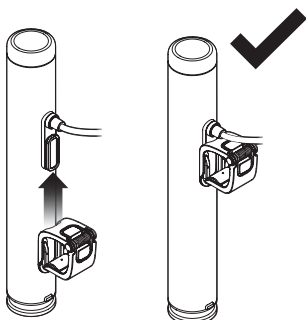

## Storing The Joule

4.1

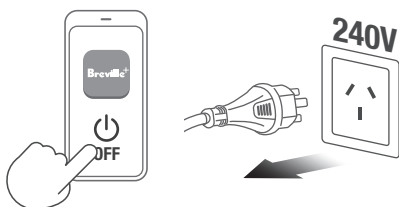

4.2

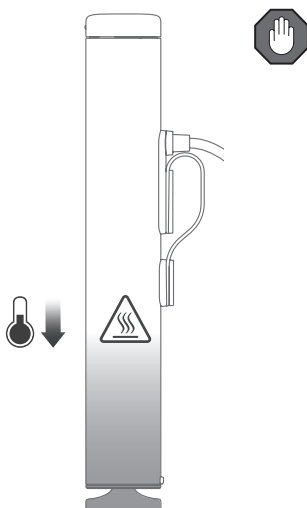

4.3

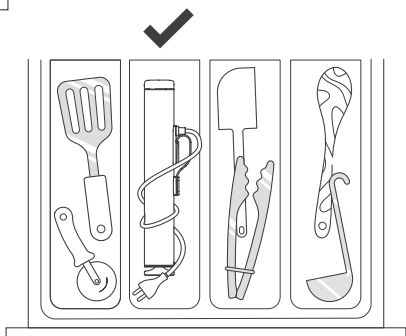

## Care & Cleaning

5.1

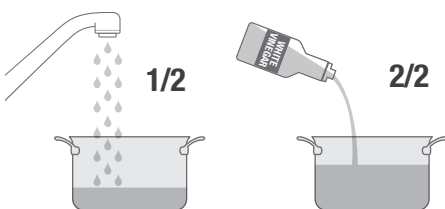

5.2

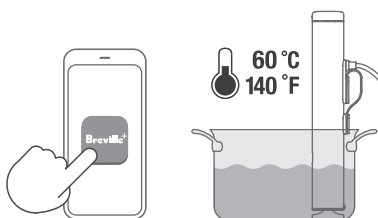

5.3

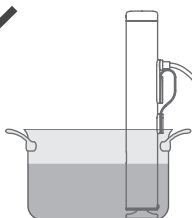

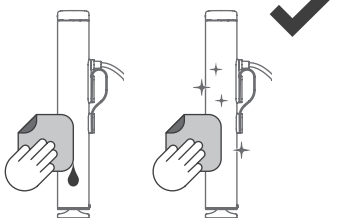



# Limited Product Warranty

## **1 YEAR LIMITED PRODUCT WARRANTY**

During the design and engineering of this product, quality was at the forefront of each material and component choice we made, which is why we proudly stand by it with a 1 Year Limited Product Warranty.

In Australia our goods come with guarantees that cannot be excluded under the Australian Consumer Law. You are entitled to a replacement or refund for a major failure and for compensation for any other reasonably foreseeable loss or damage. You are also entitled to have the goods repaired or replaced if the goods fail to be of acceptable quality and the failure does not amount to a major failure.

In New Zealand our goods come with guarantees that cannot be excluded under the Consumer Guarantees Act 1993.

So, as well as your statutory rights referred to above and any other rights and remedies you may have under any other laws relating to your Breville product, we also provide you with a Breville warranty. It's important to note that this warranty is valid only in the country of purchase. However, in other countries it is possible that other statutory warranties may still apply.

Breville's warranty for this product covers the repair or replacement (at Breville's discretion) if it's found to be defective due to faulty materials, workmanship, or function within the warranty period and will not extend the term of the original product warranty period.

To the extent permitted by law, this Breville Limited Product Warranty excludes liability for consequential loss or any other loss or damage caused to property or persons arising from any cause whatsoever. It excludes defects caused by the product not being used in accordance with instructions, by accidental damage, by misuse, or by being modified, altered, or tampered with by unauthorised persons. It excludes damage caused by insects or vermin and claims based on the presence of insects or vermin. It also excludes breakables such as glass and ceramic items, consumable items such as those that require periodic replacement as part of the ordinary use, lack of care or maintenance of the product or as directed by the instruction booklet, minor cosmetic issues (including, without limitation, paint and coatings) and normal wear and tear, and does not cover the cost of claiming under the warranty or transporting the goods to and from the place of purchase.



For support with your Breville product or to make a claim under the Breville Warranty please contact our Breville Customer Care Team on:

**Australia:** 1300 139 798  
**New Zealand:** 0800 273 845

Our Breville Customer Care Team can often diagnose and resolve most issues over the phone. In the event your product needs to be inspected or repaired, our Breville Customer Care Team will assist in arranging shipping at no charge by providing you a pre-paid label or nearest drop off point. Once the item is received and the nature of the fault is determined we'll advise what remedy you may be entitled to under the Breville Warranty. To obtain benefits under this Product Warranty, you will need to provide a proof of purchase in a form sufficient for us to verify your purchase, including the product, date of purchase and purchase price. We therefore urge you to retain this portion of the warranty card and the purchase receipt during the warranty period.

And if for any reason you wish to contact us in writing, please do so at:

**Breville**  
**Customer Service Centre**  
**Australia**  
**Locked Bag 2000**  
**Botany NSW 1455**

**Breville**  
**Customer Service Centre**  
**New Zealand**  
**PO Box 99027**  
**Newmarket 1149, Auckland**

**Or click on Support at [www.breville.com](http://www.breville.com)**

## REGISTER YOUR WARRANTY AND GET MORE FROM YOUR PURCHASE.

Warranty registration takes only a few minutes and ensures a record of your purchase and your warranty exists where it should. Registration also makes it faster and easier to get support or advice on any future question or issue you may have, and if you wish to, you can also select to be sent **free recipes, tips, tricks and other relevant information.**



Go to [www.breville.com](http://www.breville.com) and follow the prompts.

## WHAT'S ON YOUR MIND?

Our constant desire is to improve the quality and features of our wide range of home appliances. We welcome comments, ideas and constructive suggestions.



Go to [www.breville.com](http://www.breville.com) and follow the prompts.



## Notes

# Breville Service Centre

## **Australian Customers**

Phone: 1300 139 798

Web: [www.breville.com](http://www.breville.com)

## **New Zealand Customers**

Phone: 0800 273 845

Web: [www.breville.com](http://www.breville.com)

# **Breville®**

## **Master Every Moment®**

Breville, the Breville Logo, Barista Express and Temp Control are trademarks of Breville Pty Ltd ("Breville") and Breville's products are distributed in Australia and New Zealand under license. Copyright Breville Pty. Ltd. 2024.

Due to continued product improvement, the products illustrated/photographed in this brochure may vary slightly from the actual product.