

# the Fresh to Go™

Instruction Book - Suits all LPB320 models



# Breville®



## CONTENTS

- 2 Limited Product Warranty
- 2 Breville® Recommends Safety First
- 8 Components
- 9 Functions
- 11 Care & Cleaning
- 12 Troubleshooting Guide



## LIMITED PRODUCT WARRANTY

Breville's warranty for this product covers the repair or replacement if it's found to be defective due to faulty materials, workmanship, or function within the warranty period. All legal warranty rights under applicable national legislation will be respected and will not be impaired by our warranty. For details on length of warranty, to obtain a printed copy or to read full terms and conditions please scan the QR code or visit **www.breville.com**. Alternatively, call the Breville Service Centre (see back cover for QR149 contact details).

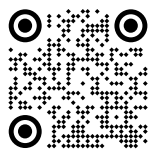

QR149

## BREVILLE® RECOMMENDS SAFETY FIRST

At Breville® we are very safety conscious. We design and manufacture consumer products with the safety of you, our valued customer, foremost in mind. In addition, we ask that you exercise a degree of care when using any electrical appliance and adhere to the following precautions.

## IMPORTANT SAFEGUARDS READ ALL INSTRUCTIONS BEFORE USE AND SAVE FOR FUTURE REFERENCE

- Carefully read all instructions before operating the blender for the first time and save for future reference.
- Remove and safely discard any packaging material and promotional labels before using the blender for the first time.
- Do not place the blender near the edge of a bench or table during operation. Ensure the surface is level, clean and free of water and other substances. Vibration during operation may cause the blender to move.
- Do not use the blender on a sink drain board.

- Do not place the blender on or near a hot gas or electric burner, or where it could touch a heated oven.
- Handle the blender and attachments with care – remember the blades are razor sharp and should be kept out of reach of children.
- Use only tumblers, blade assembly and accessories that are supplied with the blender. The use of attachments or accessories not manufactured or specified by Breville may cause the risk of fire, electrical shock, or injury.
- Always ensure the blender is assembled properly before using. Blades must be firmly secured to tumbler before operation to ensure internal contents do not escape or spray.
- Never attempt to operate or place the blade assembly onto the motor base without the tumbler in place.
- Always completely assemble the blade assembly onto the tumbler before locking to the motor base.
- Always ensure the blender is completely assembled before operating. The blender will not operate unless properly assembled.
- Keep fingers, hands, knives and other utensils away from moving blades.
- Do not attempt to operate the blender by any method other than those described in this booklet.
- Always switch off the blender at the power outlet and unplug the power cord from the power outlet before attempting to move the blender when not in use, if left unattended, and before disassembling, cleaning or storing.
- Unlock the assembled tumbler from the motor base. Ensure the motor and the blades have completely stopped before disassembling.
- Care should be taken when removing the blended mixture from the assembled tumbler. Always unscrew the assembled tumbler with the blade assembly on the top of the tumbler.
- Do not operate the blender continuously for periods longer than 1 minute at a time or if processing a heavy load. Allow to cool for at least 2 minutes after each use. If the blender is operated continuously for too long, it should be allowed to rest for 30 minutes before recommencing.
- Under a heavy load, do not operate continuously for more than 1 minute. Allow the motor to rest for 2 minutes between uses on heavy loads. A heavy load is defined as per the appliance safety standard specified load

(tumbler filled to the MAX line with a mixture comprising two parts by mass of soaked diced carrots and 3 parts water). Any load equivalent to this or heavier should not be operated for more than 1 minute at a time. Note that none of the recipes supplied with this product are considered heavier than this load.

- Do not overload the tumbler as an overload may cause the motor to stall. If the motor stalls, remove the tumbler from the motor base immediately, unplug the blender from the power outlet and let the motor cool down for at least 30 minutes.
- Do not use if the blender becomes damaged in anyway, such as if the tumbler is cracked.
- Never attempt to operate the blender with damaged blades, or with utensils, or any foreign objects inside the tumbler.
- The blender is intended for food or drinks preparation. Do not use for anything other than food or drinks. Do not operate without any ingredients in the tumbler.
- Never blend hot or warm ingredients in the blender. Allow ingredients to cool before placing into the tumbler.
- Do not put the tumbler in extremes of heat or cold, for example placing a cold tumbler into hot water, or vice versa.
- Do not open a pressurised tumbler as it may lead to ingredients splattering, or may cause burning/scalding if the contents are hot.
- Never blend hot or warm ingredients. Stop the blending process if contents become hot due to blending.
- Never blend any ingredients for more than 1 minute. Blending for more than 1 minute may cause the ingredients to become hot and steam may cause the tumbler to become pressurised.
- Never attempt to unscrew the blade assembly from the tumbler when the tumbler becomes pressurised due to steam build-up. Allow tumbler to cool to room temperature before carefully unscrewing the blade assembly base.
- Never blend carbonated liquid, detergent, or any ingredient that could expand or generate a gas.
- Never overfill the tumbler beyond the tumbler's MAX line. Some mixtures increase in volume during blending.
- If leakage occurs during blending, immediately stop blending and unplug the blender from the power outlet. Check to ensure that the tumbler is not filled past the MAX line and that there is no damage to the seal or the tumbler. Clean up the leakage with a dry towel and

screw the tumbler firmly to the blade assembly before resuming blending.

- Do not use the blender to knead dough or other heavy mixtures.
- Do not place large pieces of solid or frozen foods into the tumbler. Always break into smaller pieces before blending.
- Do not use the blender to crush only ice cubes. Ice cubes can only be blended with liquid in the tumbler using the blade assembly.
- Always switch off the blender and disconnect from the power outlet before changing accessories or approaching parts that move in use.
- Do not move the blender whilst in operation.
- Do not leave the blender unattended when in use.
- Do not place any part of the blender in a microwave oven.
- Do not place anything on top of the motor base and/or the tumbler, when in use and when stored.
- The blender shall not be used by children. Keep the blender and its cord out of reach of children.
- The blender can be used by persons with reduced physical, sensory or mental capabilities or lack of experience and knowledge if they have been given supervision or

instruction concerning use of the blender in a safe way and if they understand the hazards involved. Children shall not play with the blender.

- Do not allow children to use the blender without supervision.
- Do not use the blender with wet hands.
- Do not place the blender in direct sunlight. Colour fading and discolouration may occur when the blender is consistently exposed to UV light.
- Care should be taken when handling the sharp blades, emptying the tumbler and during cleaning.
- Keep the blender clean. Follow the cleaning instructions provided in this book.



## **IMPORTANT**

In order to avoid a hazard due to inadvertent resetting of the thermal cut-out, this appliance must not be supplied through an external switching device, such as a timer, or connected to a circuit that is regularly switched on and off by the utility.



## **WARNING**

Do not immerse the motor base, power cord or power plug in water or any other liquid.



## WARNING

Always operate the blender with the tumbler in position as indicated in the instructions.

Never put fingers or hands to the blade assembly onto the motor base without the tumbler in place.

### IMPORTANT SAFEGUARDS FOR ALL ELECTRICAL APPLIANCES

- Fully unwind the power cord before use.
- Connect only to a 230V or 240V power outlet.
- Do not let the power cord hang over the edge of a bench or table, touch hot surfaces or become knotted.
- To protect against electric shock, do not immerse the power cord, power plug or appliance in water or any other liquid or allow moisture to come in contact with the part, unless it is recommended in the cleaning instructions.
- Children should be supervised to ensure that they do not play with the appliance.
- It is recommended to regularly inspect the appliance. To avoid a hazard do not use the appliance if power cord, power plug or appliance becomes damaged in any way. Return the entire appliance to the nearest

authorised Breville Service Centre for examination and/or repair.

- The appliance is not intended for use by persons (including children) with reduced physical, sensory or mental capabilities, or lack of experience and knowledge, unless they have been given supervision or instruction concerning use of the appliance by a person responsible for their safety.
- Any maintenance other than cleaning should be performed at an authorised Breville Service Centre.
- This appliance is for household use only. Do not use this appliance for anything other than its intended use. Do not use in moving vehicles or boats. Do not use outdoors. **Misuse may cause injury.**
- The installation of a residual current device (safety switch) is recommended to provide additional safety protection when using electrical appliances. It is advisable that a safety switch with a rated residual operating current not exceeding 30mA be installed in the electrical circuit supplying the appliance. See your electrician for professional advice.
- During electrical storms, the appliance should be disconnected from the power

source at the wall socket to prevent any electrical surges that may arise during the storm and which may inadvertently cause damage to the appliance and its electronic componentry.

- Always turn the appliance to the off position by switching off at the power outlet and unplugging from the power outlet.
- Before cleaning, always turn the appliance to the off position, switch off at the power outlet, unplug at the power outlet and remove the power cord, if detachable, from the appliance and allow all parts to cool.
- Do not place this appliance on or near a heat source, such as a hot plate, oven or heaters.
- Position the appliance at a minimum distance of 20cm away from walls, curtains and other heat or steam sensitive materials and provide adequate space above and on all sides for air circulation.

## **POWER MANAGEMENT FUNCTION**

The blender has a power management function.

The blender switches to 'standby' mode immediately once it is plugged in or after it has been used. The 'standby' mode power consumption is 0.5W.

Under this mode, the blender consumes low power if it is kept plugged into a switched-on power outlet.

To save energy, turn the blender to the STANDBY position, switch off at the power outlet and unplug at the power outlet if the blender is not in use.

# **FOR HOUSEHOLD USE ONLY SAVE THESE INSTRUCTIONS**



## COMPONENTS

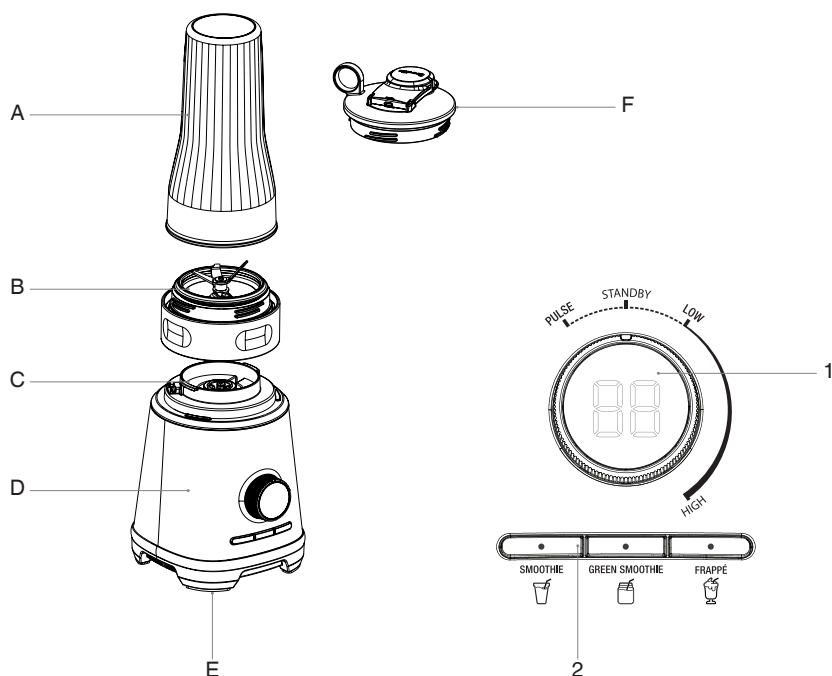

- A. 850ml BPA-Free Tritan™ Tumbler\* x 2
- B. Blade assembly
- C. Top cover
- D. Motor base
- E. Non-slip rubber feet
- F. Portable lid x 2

- 1. Control dial with LED timer
- 2. Preset buttons



### WARNING

Blades are extremely sharp and should be kept out of reach from children. Handle with care.

\*850ml total tumbler capacity. 600ml capacity to MAX line. Do not exceed the MAX fill capacity.





## FUNCTIONS

### BEFORE FIRST USE

- Before using your personal blender for the first time, remove any packaging material and promotional labels.
- Wash the tumblers and lids in warm soapy water with a soft cloth. Rinse and dry thoroughly.
- Rinse blades with water. Wipe out the blade assembly with a slightly damp cloth and dry thoroughly.



### WARNING

Blades must be handled carefully as they are extremely sharp!

Do not immerse the blade assembly, motor base, power cord or power plug in water or any other liquid.

### ASSEMBLY

1. Place the motor base on a flat, dry surface. Ensure that the blender is switched off at the power outlet and unplugged.
2. Add ingredients to the tumbler, ensuring they do not exceed the MAX line. Always add liquid first before blending. Never operate the blender with dry ingredients only.
3. Fix the blade assembly to the open end of the tumbler by turning in a clockwise direction. Ensure the blade assembly collar is securely fastened in place.
4. Secure the assembled tumbler and blade assembly to the top cover by aligning the ▼ arrow with the 🔓 unlock, then turning clockwise until the ▼ arrow aligns with the 🔒 lock. A click should sound.



### NOTE

Ensure you use the grooves on the blade assembly to secure in place. Do not attempt to turn by holding the tumbler.

### OPERATING YOUR BREVILLE FRESH TO GO™



### NOTE

When first using your personal blender, you may notice an odour coming from the motor. This is normal and will dissipate with use.

1. Ensure the dial is at the STANDBY position.
2. Plug the power plug into a 230/240V power outlet and turn on the power outlet.
3. The LED dial should flash '00' to indicate the unit is on standby mode.
4. Use either the desired preset program button or dial to blend the ingredients.
5. Once blending is complete, remove the assembled tumbler from the motor base by gripping the grooves on the blade assembly collar and turning anticlockwise until the ▼ arrow moves from the 🔒 lock to the 🔓 unlock, then lift it away from the motor base.



### WARNING

Never remove the assembled tumbler from motor base by turning the tumbler. It may cause the ingredients and liquids leaking from the tumbler.

6. Flip the assembled tumbler so that the blade assembly faces upwards. Carefully unscrew the blade assembly collar anticlockwise to detach from the tumbler. Avoid touching the sharp blades.
7. Attach the portable lid to the tumbler if drinking directly from it.
8. After use, ensure the motor base is switched off at the power outlet and unplug the power cord. Allow the motor base to cool before cleaning and storing.



### NOTE

Once the blending operation has completed, the dial must be returned to the STANDBY position before the personal blender can be activated again.

## SPEED DIAL & PULSE

- Turn the dial clockwise to increase speed (LOW to HIGH) or anticlockwise to decrease speed. You can adjust the speed at any time during blending.
- The personal blender will operate at the selected speed for 60 seconds, with the LED dial counting up, unless manually returned to STANDBY. When finished, '00' will flash.
- To use the pulse function, turn the dial anticlockwise to the PULSE position. Release the dial and it will return to STANDBY and stop operation.
- 'PL' will illuminate on the LED dial when PULSE is engaged, and '00' will then illuminate when back to STANDBY.



### NOTE

Do not operate PULSE for longer than 1 minute.

## PRESET PROGRAMS

This personal blender comes equipped with 3 preset programs for a more customised result; Smoothie, Green Smoothie, and Frappé.

- The dial must be at the STANDBY position before using the preset programs.
- Press the desired preset program button. The selected button will illuminate white, a 60-second countdown timer will appear on the LED dial, and the blender will automatically begin operation.
- The LED dial will flash '00' when the program has finished.
- To cancel the preset program at any time during operation, press the chosen program button again.

Preset Program	Perfect For
Smoothie	Smoothies containing soft fruit
Green Smoothie	Smoothies containing fibrous leafy greens or vegetables
Frappé	Drinks containing frozen fruit or ice

## OVERLOAD PROTECTION SYSTEM

- The personal blender is equipped with an internal self-resetting overload protector to prevent motor damage from excessive load or continuous loads. If the blender suddenly stops during operation, the overload protector may have tripped.
- If this occurs, remove the assembled tumbler, unplug the blender, and leave it to cool for at least 30 minutes. Do not reattach the assembled tumbler while cooling as the protector may reset causing the blender to start unexpectedly.
- A tripped overload protector indicates that the blender has been overloaded or used continuously for too long. Reduce the amount of ingredients used or allow more time between blending cycles to prevent this from happening again, which will help preserve the life of the motor.
- Ensure the MAX line has not been exceeded; however, some especially dense ingredient combinations may still strain the motor. If the motor seems to be straining or running slowly, only operate for 10 seconds at a time, reduce the ingredient quantity, or add more liquid to loosen dense mixtures.

## HINTS & TIPS:

- Never blend hot (or even warm) ingredients. The tumbler seals with the blade assembly, and there is no venting to release steam.
- Avoid blending longer than recommended, or for more than 1 minute at a time. Over-blending can cause ingredients to warm up, increasing internal pressure on the seals, making the tumbler difficult to open or causing splattering. Allow to cool and take care when opening.
- Always add liquids for optimum blending. If the ingredients are not circulating properly, add more liquid.
- If the results are lumpy, try reducing the ingredient quantity, or blending in smaller batches.
- Use the PULSE function for thick mixtures to help ingredients circulate more effectively.
- Do not exceed the MAX line when adding ingredients and liquids to the tumbler.
- The unit will not operate if the assembled tumbler is not securely positioned.
- The maximum amount of ice cubes or frozen fruit the blender can process is a ratio of 50% frozen ingredients to 50% liquid. For better blending results, cut fruit into standard ice cube-sized pieces before freezing.



## CARE & CLEANING

Always unplug the power cord from the power outlet after use for safety reasons.

### Tumblers, Blade Assembly & Lids

To keep your tumblers, blades and lids clean, avoid allowing food residue to dry on them.

Follow these steps as soon as possible after use:

- Remove the seals from the underside of the lid and lid spout. Clean in warm soapy water and wait for the seals to fully dry before reassembling.
- Rinse most of the residue off the blades, tumblers and lids.
- Wipe out the blade assembly with a slightly damp cloth and dry thoroughly.
- Hand wash tumblers and lids in warm, soapy water using a mild liquid detergent and non-abrasive sponge.



### WARNING

Blades must be handled carefully as they are extremely sharp!



### WARNING

Do not immerse the blade assembly, motor base, power cord or power plug in water or any other liquid.

### Motor Base

To clean the motor base, wipe with a soft, damp cloth then dry thoroughly. Wipe any excess food particles from the power cord.



### NOTE

There are rubber seals situated under the lids and in the removable blade assembly to prevent leaking. In case these seals come out, wash in warm soapy water, rinse and dry thoroughly. Correctly refit the seals into the lid or inside the blade assembly before using.

### Cleaning Agents

Do not use abrasive scouring pads or cleansers on either the motor base or the tumblers, as they may scratch the surface. Use only warm soap water with a soft cloth.

### Pressurisation

The tumblers may be rinsed by adding cold water, attaching blades, and either blending or shaking by hand for 10 seconds.



### IMPORTANT

There is a risk of pressurisation from hot water and/or detergent. When rinsing by attaching blades and blending/shaking, never add hot or even warm water, as the steam produced can create dangerous pressurisation of steam. Do not add detergent, as the foam produced will expand and may cause pressurisation.

### Dishwasher

The tumblers, lids and blade assembly may be washed in the dishwasher on the top shelf only. Be aware that washing parts on a regular base in the dishwasher can shorten the life of them due to prolonged exposure to harsh detergents, hot water and pressure.



### NOTE

Stubborn food stains and odours, strong smelling foods such as cumin and coriander, and some vegetables such as carrots may leave an odour or stain the blades, tumbler or lid. To remove, pour warm soapy water and fill to the MAX mark. Set aside to soak for 5 minutes. Then wash with a mild detergent and warm water, rinse well and dry thoroughly. Store tumblers with lids off.

### Citrus

Exposure to citrus oil may affect the clarity and longevity of the tumblers. After washing in detergent, rinse with plain water thoroughly, and allow to dry immediately. Do not soak if citrus has been blended.

### STORAGE

Before storing, thoroughly wash and dry all removable parts. Store upright with the tumblers and blades assembled and resting on the motor base, or beside it. Store out of reach of children. Do not store anything on top of the blender.



## TROUBLESHOOTING

Problem	Possible Cause	What to Do
<b>Motor doesn't start or blade doesn't rotate</b>	<ul style="list-style-type: none"><li>• The blender is not turned on.</li><li>• The control dial is not reset to the STANDBY position.</li></ul>	<ul style="list-style-type: none"><li>• Check that the power plug is properly inserted into the power outlet.</li><li>• Reset the control dial to the STANDBY position.</li></ul>
<b>Blender stopped suddenly while in use</b>	<ul style="list-style-type: none"><li>• The blender has overload protection to prevent damage to the motor, which may have operated.</li></ul>	<ul style="list-style-type: none"><li>• Unplug, remove the tumbler and allow the motor to cool down for 30 minutes. Once cooled, you will be able to use as usual again.</li><li>• We recommend blending in smaller batches, or cutting ingredients into smaller pieces. See Overload Protection System section for detailed information.</li></ul>
<b>Food is lumpy or unevenly blended</b>	<ul style="list-style-type: none"><li>• Too much food is being blended at one time.</li><li>• The ingredients may be too large.</li></ul>	<ul style="list-style-type: none"><li>• Use a smaller amount, and work in batches if necessary.</li><li>• Cut food into smaller pieces. For best results, ingredients should be in pieces no larger than 2cm.</li></ul>
<b>Food sticks to blade and cup</b>	<ul style="list-style-type: none"><li>• The mixture may be too thick.</li></ul>	<ul style="list-style-type: none"><li>• Add more liquid and/or pulse the blender.</li></ul>



## NOTES



## NOTES



## NOTES

## Breville Customer Service Centre

### **Australian Customers**

**Phone:** 1300 139 798

**Web:** [www.breville.com](http://www.breville.com)

### **New Zealand Customers**

**Phone:** 0800 273 845

**Web:** [www.breville.com](http://www.breville.com)

# Breville®

Master Every Moment™

Breville, the Breville Logo and Fresh to Go are trademarks of Breville Pty Ltd ("Breville") and Breville's products are distributed in Australia and New Zealand under license.

All other brands may be trademarks of their respective owners.

Copyright Breville Pty. Ltd. 2025.

Due to continued product improvement, the products illustrated/photographed in this booklet may vary slightly from the actual product.