



the Luxe Brewer™ Glass & Thermal

BDC415 & BDC465

Breville®

 Safety Guide

EN CONTENTS

2. Limited product warranty
2. Breville® recommends safety first
6. Components
7. Accessories
8. Unboxing
8. Care and cleaning
9. Water filter assembly
10. Setting water hardness and first use flush cycle
11. Setting the clock
13. Brew into a carafe
15. Keep warm feature
16. QR code web access

LIMITED PRODUCT WARRANTY

2 YEAR LIMITED

Breville's warranty for this product covers the repair or replacement if it's found to be defective due to faulty materials, workmanship, or function within the warranty period.

All legal warranty rights under applicable national legislation will be respected and will not be impaired by our warranty. For details on length of warranty, to obtain a printed copy or to read full terms and conditions please scan the QR code or visit www.breville.com. Alternatively, call the Breville Service Centre (see back cover for contact details)



QR149

BREVILLE® RECOMMENDS SAFETY FIRST

At Breville® we are very safety conscious. We design and manufacture consumer products with the safety of you, our valued customer, foremost in mind. In addition, we ask that you exercise a degree of care when using any electrical appliance and adhere to the following precautions.

IMPORTANT SAFEGUARDS

Read all instructions before use and save for future reference.



BD0415



BD0465

- Remove and safely discard any packaging material, plastic power plug cover, and any removable labels before using appliance.
- Ensure the product is properly assembled before use and fully unwind the power cord before operating.
- If the appliance is to be left unattended, cleaned, moved, assembled or stored, unplug the unit from the power outlet.
- Always operate the appliance on a stable and heat resistant surface.
- Do not place the appliance on or near a hot gas burner, electric element or where it could touch a heated oven.

- Ensure the unit has at least 10 cm (4 inches) of clearance from all side panels.
- Do not operate the appliance without water in the water tank. Use only cold, preferably filtered water. Do not fill the appliance with any other liquids for brewing operations.
- We recommend using cold, filtered water. We do not recommend the use of de-mineralized or distilled water as this may affect the taste of brewed coffee.
- Ensure the supplied mesh basket filter or a paper filter (8-12 cup, flat base basket style with 8.25 cm (3 1/4 inches base) is placed in the coffee basket before using the appliance. Do not use the mesh basket filter in conjunction with a paper filter.
- Before starting a brew cycle:
 - Check that the carafe drip stop moves up and down freely.
 - Completely empty the carafe and securely lock the carafe lid in place.
 - Insert and seat the carafe under the drip stop.
 - Ensure the filter basket is empty and properly fit in place.
- During a brew cycle:
 - Do not remove the carafe or remove the filter basket while the unit is in a brew cycle. Failure to follow the above may lead to scalding or serious injury.
- Some surfaces may be hot, use caution when touching or lifting the unit or accessories.
- Use only carafe handle when lifting or carrying the carafe.
- The carafe is designed for use with this appliance only. It must never be used on a range top or in a microwave.
- Scalding may occur if the carafe lid or basket is removed during the brewing cycle.



CAUTION

Risk of injury. Proper installation or removal of basket is required to reduce the risk of splashing of hot water.

- Always ensure the carafe lid is securely locked in place onto the carafe before pouring.
- Do not use the carafe with a cracked, loose, weakened or damaged handle.
- Do not use the filter basket with a cracked, loose, weakened or damaged handle.
- Always wait until the machine has cooled before removing the brew basket.
- Do not touch hot surfaces. Use the handle for lifting and carrying the carafe.

- Do not set a hot carafe on a wet, cold or heat sensitive surface.
- Unplug from outlet when the appliance before cleaning and storing. Allow to cool before putting on or taking off parts.
- The use of attachments not sold or recommended by Breville may cause fire, electric shock or injuries.
- Proper installation of filter basket, shower-head seal and shower-head locking ring is required to reduce the risk of splashing of hot water.



CAUTION

To prevent damage to the appliance do not use alkaline cleaning agents when cleaning, use a soft cloth and a mild detergent.

- Do not use harsh or abrasive materials when cleaning any part of this appliance such as steel wool or scoring pads.
- The heating element surface is subject to residual heat after use.
- The appliance shall not be placed in a cabinet when in use.
- Improper use of the appliance, incorrectly operated, or unprofessionally repaired will void any warranty.
- Servicing other than cleaning should be performed by an authorized service representative or at an authorized Breville Service Centre.

IMPORTANT SAFEGUARDS FOR ALL ELECTRICAL APPLIANCES

- Do not let the cord hang over the edge of a bench or table, touch hot surfaces, or become knotted.
- Do not leave the appliance unattended when in use.
- Children should be supervised to ensure they do not play with the appliance.
- Close supervision is necessary when the appliance is used by or near children.
- This appliance can be used by persons with reduced physical, sensory or mental capabilities or lack of experience and knowledge if they have been given supervision or instruction concerning use of the appliance in a safe way and understand the hazards involved.

- This appliance can be used by children aged from 8 years and above if they have been given supervision or instruction concerning use of the appliance in a safe way and if they understand the hazards involved. Cleaning and user maintenance shall not be made by children unless they are older than 8 and supervised. Keep the appliance and its cord out of reach of children aged less than 8 years.
- This appliance is recommended for household use only. Do not use this appliance for anything other than its intended use. Do not use in moving vehicles or boats. Do not use outdoors. Misuse may cause injury.
- Regularly inspect the supply cord, plug and actual appliance for any damage. If found damaged in any way, immediately cease use of the appliance and return the entire appliance to the nearest authorised Breville Service Centre for examination, replacement or repair.
- The installation of a residual current device (safety switch) is recommended to provide additional safety protection when using electrical appliances. It is advisable that a safety switch with a rated residual operating current not exceeding 30mA be installed in the electrical circuit supplying the appliance. See your electrician for professional advice.
- The appliance is not intended to be operated by means of an external timer or separate remote-control system.



To protect against, fire, electric shock; do not immerse the power cord, power plug or appliance in water or any other liquid.



CAUTION



CAUTION HOT SURFACE

SAVE THESE INSTRUCTIONS FOR HOUSEHOLD USE ONLY



COMPONENTS

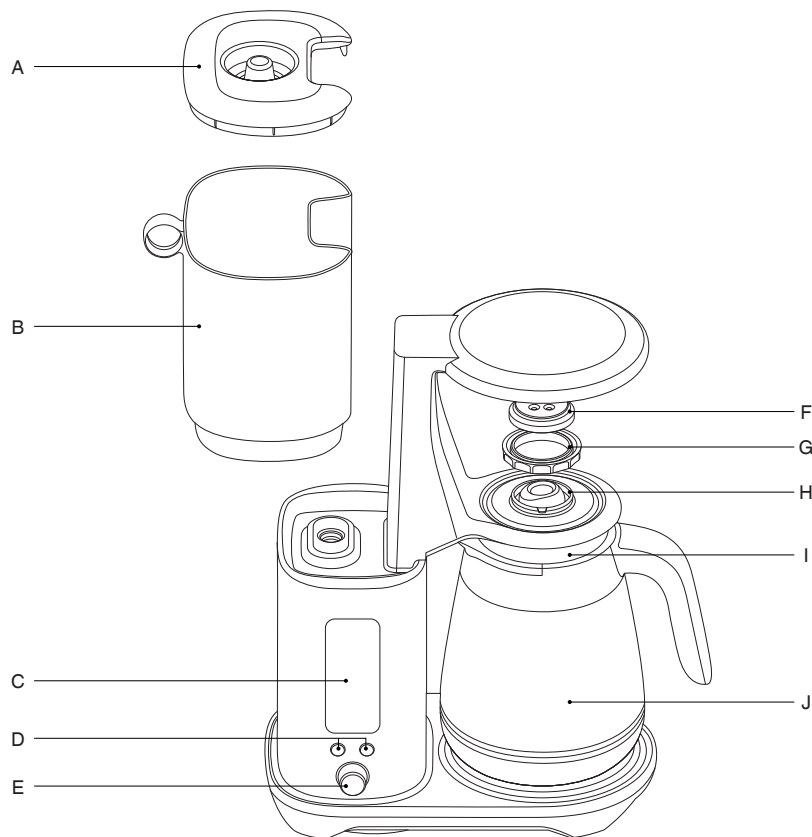

- A. Water tank lid
- B. Water tank
- C. LED display
- D. Left: Settings button
Right: Auto start button
- E. SELECT dial
- F. Showerhead
- G. Showerhead ring
- H. Drip stop lever
- I. Carafe lid
- J. Carafe

ACCESSORIES

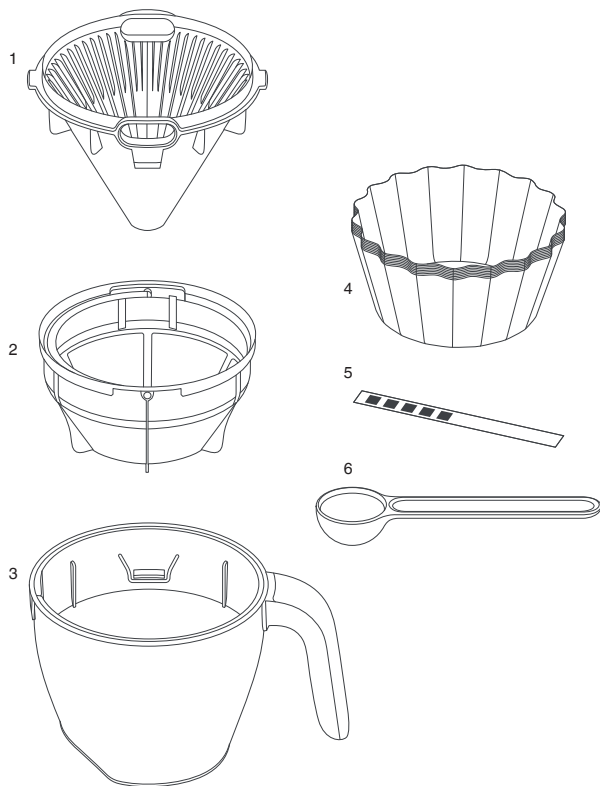

1. Cone filter basket insert
2. Mesh basket filter
3. Brew basket
4. Flat bottom basket filter paper pack (10 pieces)
5. Water hardness strip
6. Breville coffee measuring scoop

1. UNBOXING

1.1

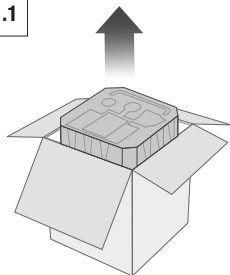

1.2

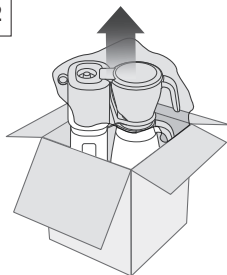

1.3

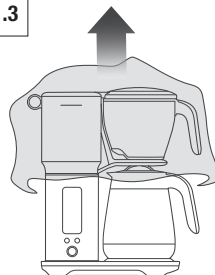

1.4

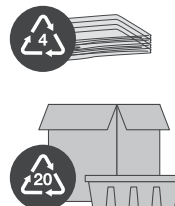

2. CARE AND CLEANING

2.1



2.2

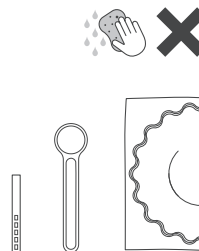

2.3

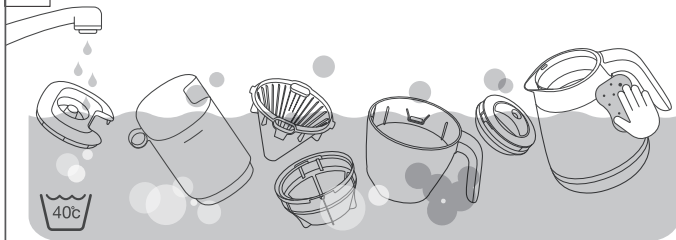

2.4

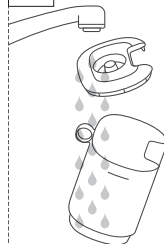

2.5

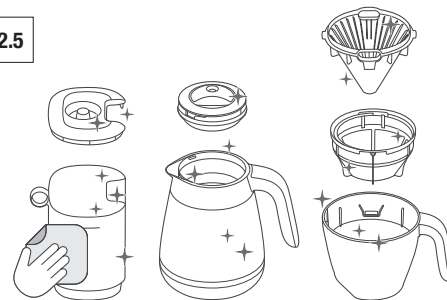

3.

WATER FILTER ASSEMBLY



NOTE

Water filter and water filter adapter not included and are sold separately.

3.1

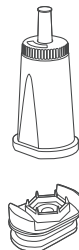

3.2

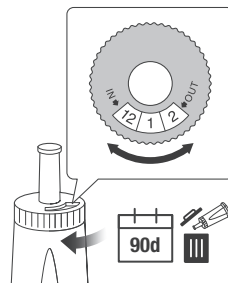

3.3



3.4

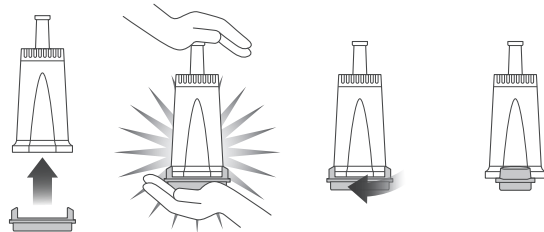

3.5

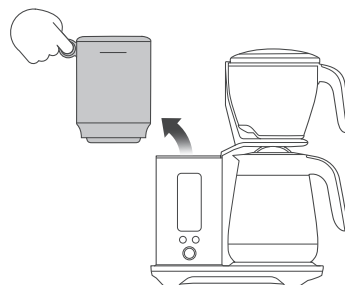

3.6

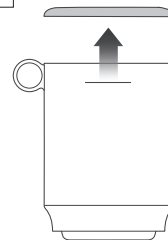

3.7

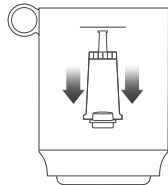

3.8

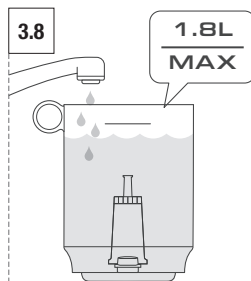

3.9

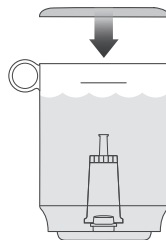

3.10

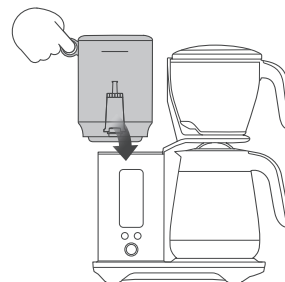

4. SETTING WATER HARDNESS AND FIRST USE FLUSH CYCLE

4.1

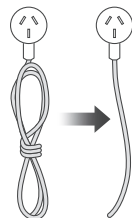

4.2

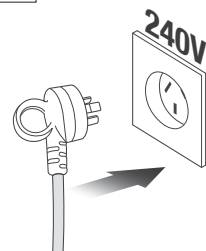

4.3

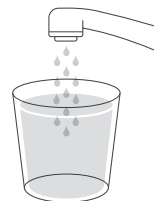

4.4



⌚ 1s

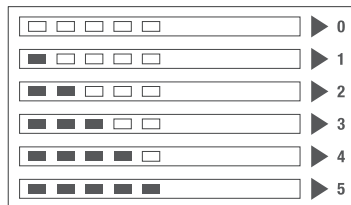

⌚ 1m

4.5

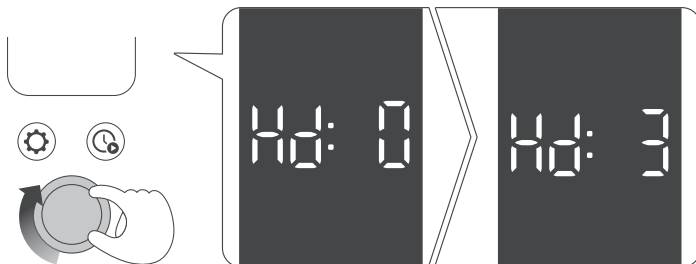

4.6

🔔 x1

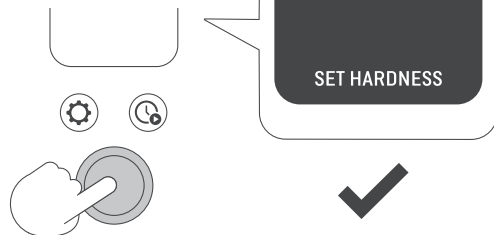

4.7

🕒

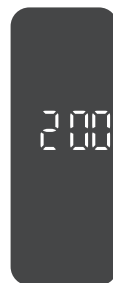

4.9

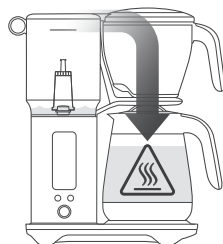
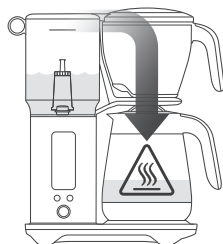
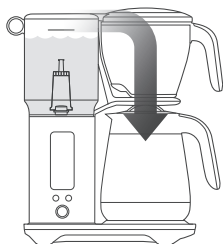

4.10



x3

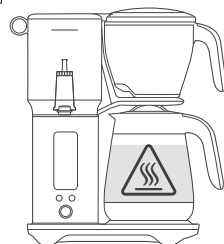

4.11

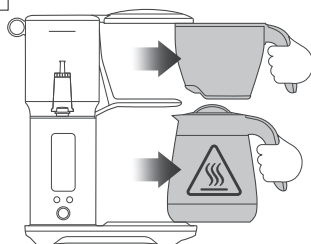

4.12



4.13

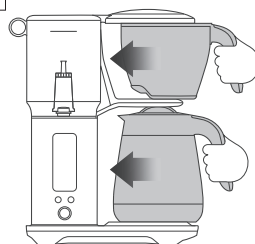

4.14

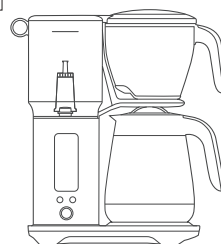

5.

SETTING THE CLOCK

5.1

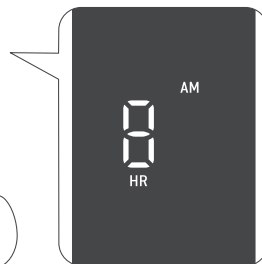
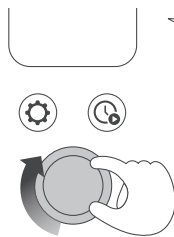

5.2



5.3

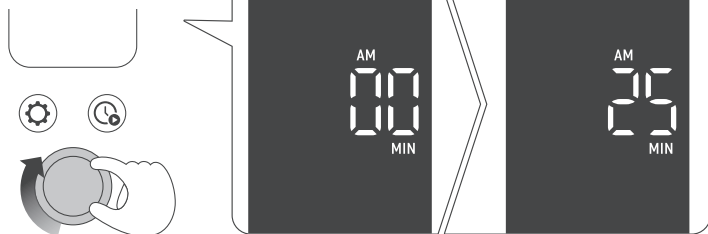

5.4

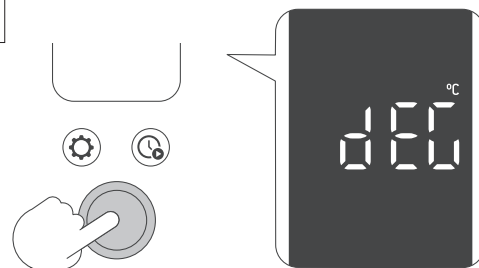

5.5



6.

BREW INTO A CARAFE

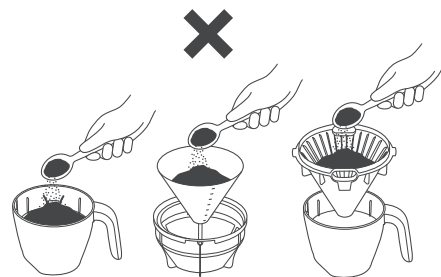
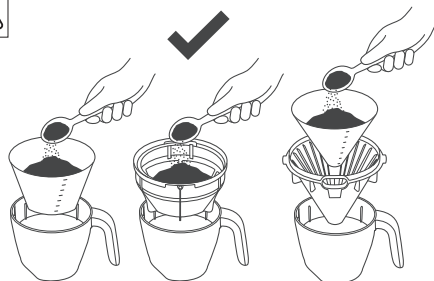

(150ml)

1

2

3

4

5

6

7

8

9

10

11

12



x1
(8.25g)

x2
(16.5g)

x3
(24.75g)

x4
(33g)

x5
(41.25g)

x6
(49.5g)

x7
(57.75g)

x8
(66g)

x9
(74.25g)

x10
(82.5g)

x11
(90.75g)

x12
(99g)



150ml

300ml

450ml

600ml

750ml

900ml

1.05L

1.2L

1.35L

1.5L

1.65L

1.8L

6.1

2-8

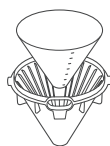

8+

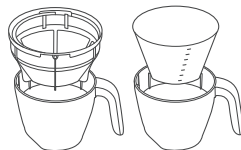

6.2

1.8L
MAX

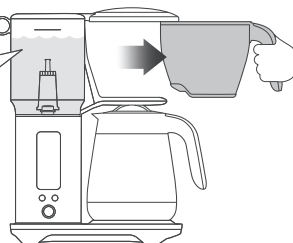

6.3

x12
(99g)

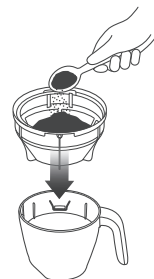

6.4

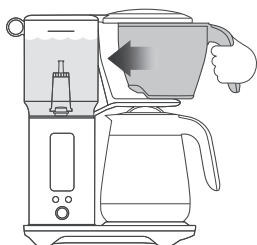

6.5

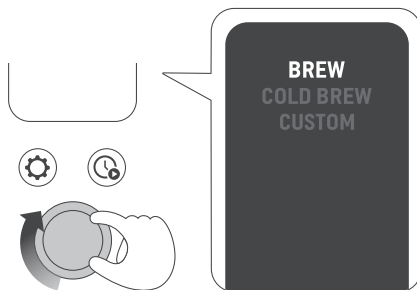

6.6

(()) x1

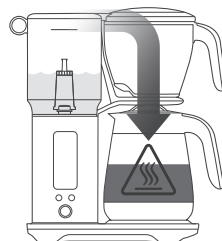
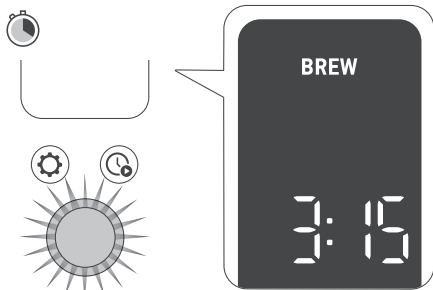

6.7

**NOTE**

Go to section 7 for the
KEEP WARM feature for
model BDC415.

6.8

(()) x1

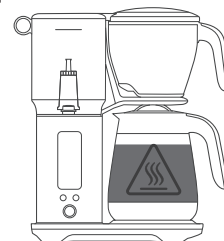

6.9

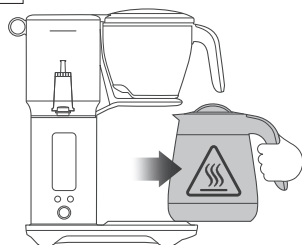

6.10

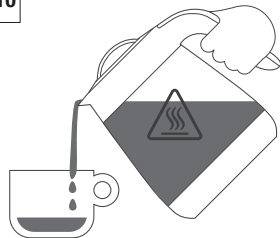

6.11



7. KEEP WARM FEATURE



NOTE

KEEP WARM FEATURE IS AVAILABLE FOR BDC415 MODEL ONLY.

7.1

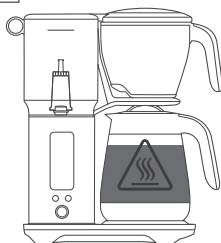

7.2



OR



7.3

(🔔) x1

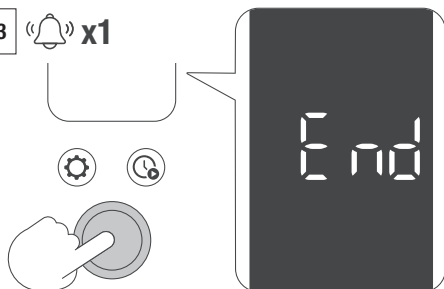

8.



BDC415



BDC465



For more information on:

- Cleaning • Troubleshooting
- Useful Tips and Warranty

Check out the website, visit www.breville.com

NOTES

NOTES

NOTES

Breville Service Center

Australian Customers

Phone: 1300 139 798

Web: www.breville.com

New Zealand Customers

Phone: 0800 273 845

Web: www.breville.com

Breville®

Master Every Moment™

Breville, the Breville Logo, is a trademark of Breville Pty Ltd ("Breville") and Breville's products are distributed in Australia and New Zealand under license. Copyright Breville Pty. Ltd. 2024.

Due to continued product improvement, the products illustrated/photographed in this brochure may vary slightly from the actual product.